

The gallery space is 59' 10.5" long by 39' 8" wide. The floor is bamboo over concrete slab. The effective wall height is 10' 5". The walls are drywall over plywood nail base. The space above the hanging wall is painted black to conceal HVAC and mechanicals. The space is illuminated by up to 75, 100 watt track lights on dimmers (four circuits). The walls are broken by 24" diameter engaged columns (columns cannot be used for hanging). Distance between columns are indicated on drawing above with an asterisk.

There are 8 modular wall units, 8' h X 8' w X 2' d, that can be positioned within the space. The reception area is bordered by floor to ceiling windows that allow natural light to enter the reception area and filter into the exhibition space through three arched portals.

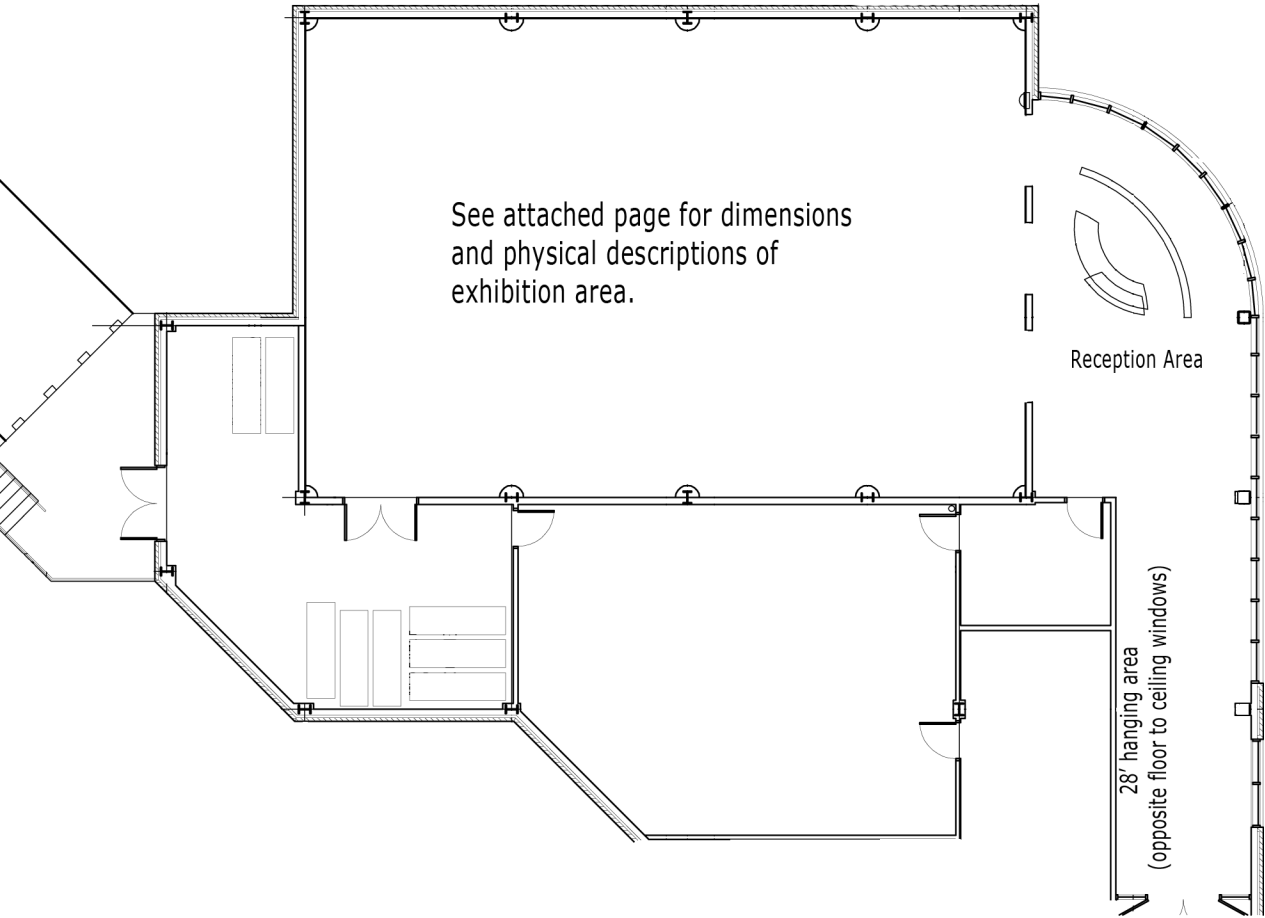

See attached page for dimensions  
and physical descriptions of  
exhibition area.

Reception Area

28' hanging area  
(opposite floor to ceiling windows)